

2007  
Newsletter  
Religious Facilities



All Saints Episcopal - Selinsgrove, PA

Robert A. Lack • AIA •  
Architecture &  
Design, Inc.

Robert A. Lack, AIA  
Architecture & Design, Inc

230 Market Street  
Lewisburg, PA 17837  
Phone (570) 524-2300  
Fax (570) 523-6140  
ralad@ralad.com

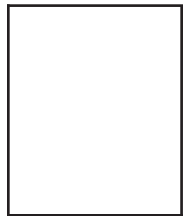

In the coming weeks we will be unveiling our new website. Please  
check back often at our site [www.ralad.com](http://www.ralad.com)



Robert A. Lack, AIA  
Architecture & Design, Inc.

## Architectural Newsletter Religious Facilities

September 2007

Serving the communities of Northeastern & Central Pennsylvania from our office in Lewisburg, Robert A. Lack, Architecture and Design, Inc. has been providing highly personal, client-friendly design services since 1984. We are committed to designing building solutions that respond appropriately to the surrounding environment and maintain the historical integrity of the area. We enjoy the working relationships we have been able to build here. We have successful long-standing relationships with several specialty consultants, which allows us to enhance our service capabilities. A professionally educated, locally rooted, personally committed staff keep the firm well entrenched within the communities of Pennsylvania.



In this Issue...

- \*Current Religious Project
- \*Completed Religious Project
- \*Resources

Feature Project:

Grace Lutheran Church  
Berwick, PA



Robert A. Lack, AIA  
Architecture & Design Welcomes  
Rory O'Hagan

Architecture & Design, Inc. is delighted to welcome Mr. Rory O'Hagan to our staff as a new draftsman. Rory graduated in December 2006 from Alfred State College, Alfred, NY with a Associates degree in Architectural Engineering Technology. Rory has decided to relocate to the Lewisburg area to continue his professional career with Architecture & Design, Inc. Welcome Rory!



# Grace Lutheran Church

Berwick, PA

Existing Photos/ Potential New Design Plans



Design options to choose from for the new church



Option A



Option B



Option C

Floor layouts to choose from for new church

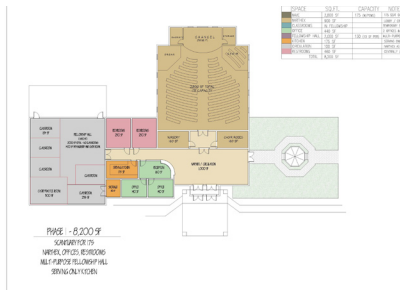

PHASE 1

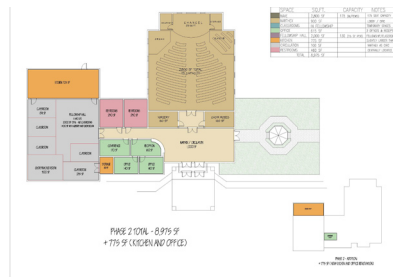

PHASE 2



PHASE 3

The congregation of Grace Lutheran was faced with the hard decision to either renovate their existing facility or leave their life long church and build new. After about 8 months of searching, a very generous member of the congregation offered the church a piece of land. We were there each step of the way to evaluate the size of the site, relationship of utilities, potential for future expansion and review of local zoning and planning requirements. We are currently working with the building committee to evaluate the needs and wishes of the congregation and design a new facility that will be able to grow as the church grows. The initial design will include at least one planned future addition of classrooms and may also include the potential to expand the fellowship hall. At each stage, the budget and proposed construction is reviewed to be able to provide a responsible design solution to the congregation of Grace Lutheran Church.

## St. Andrew's Church

Lewisburg, PA



St. Andrew's Church, located on Derr Drive in Lewisburg, PA, is one of our most recent religious facilities projects. Upon completion in 2004, we further enhanced the existing church structure by adding a new foyer and entrance way as the main focal element of the church's exterior. In compliance with the Americans with Disabilities Act, we designed the new addition and entrance way to meet the needs of the congregation. The new expansion includes a sacristy and a new kitchen area that has already proven to be very functional and useful as well as the new classroom in the church.

## All Saints Episcopal Church

Selinsgrove, PA



The project included an addition of approx. 3,500 sq. ft. The new addition includes a new Parish Hall and full size commercial kitchen. New office and grand entrance foyer provide a unique design element to the expansion project. The basement will be used for future expansion and classroom space.



## Our Services To You

We here at Robert A. Lack, AIA, Architecture & Design, Inc. have over 20 years of experience in providing churches with our successful architectural services. Whether you are looking to build an addition onto your existing Church, wishing to renovate your Church, or simply in need of some small necessary code renovations, we can help! Please contact us at your convenience to setup a free initial consultation either at your Church or our firm. We will be happy to discuss the architectural needs of your Church and also what we have to offer you.

## Client List

2007 All Saints' Episcopal Church- Hersey, PA  
2007 Holy Family Convent - Danville, PA  
2006 Cedar Run Baptist Church - Cedar Run, PA  
2006 Grace Lutheran Church- Berwick Pa  
2006 Maranatha Christian - Watsonstown, Pa  
2005 First Presbyterian Church - Bellefonte, PA  
2005 St. John's Byzantine Church - Hawk Run, PA

2004 First English Baptist Church - Bloomsburg, PA  
2003 St. Paul's Church - Wellsboro, PA  
2002 Saint Andrews' Episcopal Church - Lewisburg, PA  
2001 Berwick Bible Church - Berwick, PA  
2000 All Saints' Episcopal Church - Selinsgrove, PA  
1999 First United Church of Christ - Middleburg.PA  
1999 Saint Paul's United Methodist Church - Lewisburg, PA